

- NOTES:**
1. ALL ROAD SIGNS & MARKINGS TO COMPLY AND REFER WITH THE TRAFFIC SIGNS MANUAL (TSM) ISSUED BY THE DEPARTMENT OF THE ENVIRONMENT 2010.
 2. ALL ROAD MARKING ON ASPHALT SURFACING TO BE THERMOPLASTIC PAINT WITH REFLECTIVE BEADS
 3. ALL ROAD MARKINGS ON PAVED SURFACES TO BE SPECTRUM ROUTELINE CR PAINT OR APPROVED EQUIVALENT.
 4. ALL ROAD MARKING MATERIALS TO COMPLY WITH EU REGULATION NO.305/2011 IN RELATION TO CE MARKINGS AND DECLARATION OF PERFORMANCE (DOP).
 5. ALL PARALLEL PARKING BAYS AS PER RRM 011 OF TSM.
 6. ALL PERPENDICULAR PARKING SPACES AS PER RRM 013 OF TSM.
 7. ALL DISABLED PERSONS' PARKING BAYS AS PER FIG. 7.27 OF TSM.

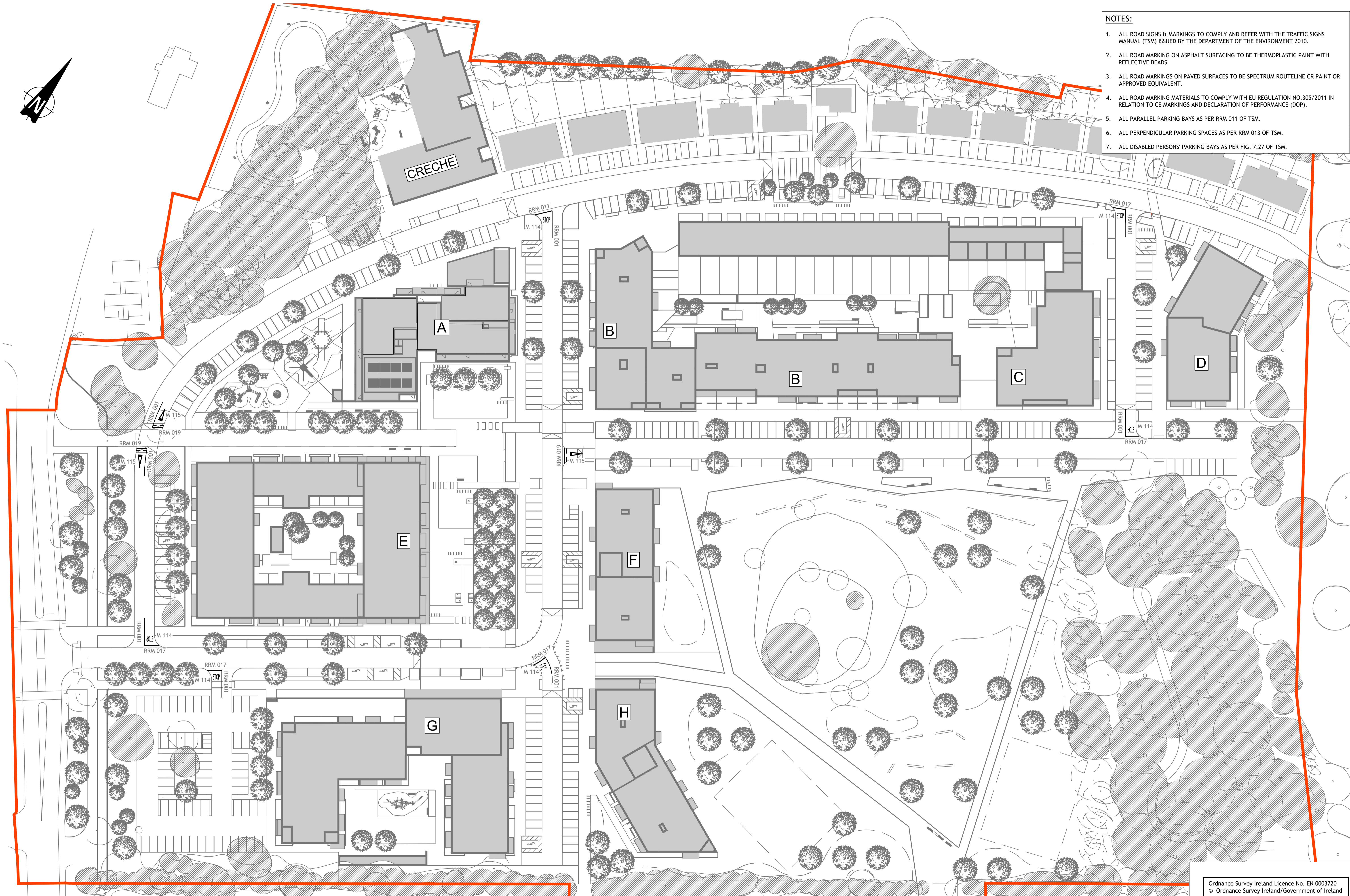

Ordnance Survey Ireland Licence No. EN 0003720
 © Ordnance Survey Ireland/Government of Ireland

© PUNCH Consulting Engineers
 This drawing and any design hereon is the copyright of the Consultants and must not be reproduced without their written consent.
 All drawings remain the property of the Consultants. Figured dimension only to be taken from this drawing. Consultants to be informed immediately of any discrepancies before work proceeds.

Date Drawn: 2019-09-23
 Drawn By: J. Bedkowski
 Date Issued: 2020-01-22
 Issued By: J. Bedkowski

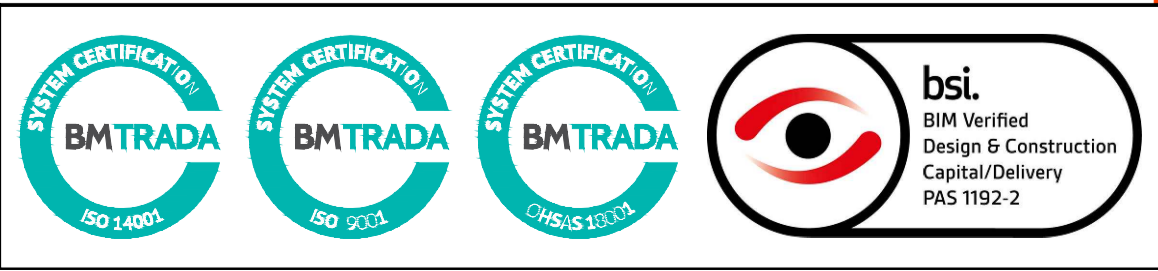

Rev	Amendment	By	Date
PL0	ISSUED FOR PLANNING	JB	2020-01-22



Job: RESIDENTIAL DEVELOPMENT SHANGANAGH CASTLE DLRC
 Title: PROPOSED ROAD MARKINGS

PUNCH consulting engineers
 Dublin | Limerick | Cork | Galway | Glasgow
 Carnegie House, Library Road, Dun Laoghaire, Co. Dublin, A96 C7W7
 IRL: +353 1 271 2200 www.punchconsulting.com

Stage: PLANNING
 Scale @ A1: 1:500
 Technician Check: P.J. Mulcahy
 Engineer Check: Philip Bayfield
 Approved: Donal Gallery
 Drawing No: 182-134-038
 Rev: PL0